



GPS ANTENNA Option G

*Professional quality L1 GPS antenna
placed in a compact and conical housing.*

The antenna features a custom high performance broadband patch element, a 40dB gain LNA stage and an out-of-band high rejection SAW filter. Equipped with a sharp SAW pre-filter to provide strong protection against out-of-band signals. It offers a bandwidth of ± 10 MHz centered on 1575.42 MHz. It offers a large axial ratio, excellent reception of circularly polarized signals, good multipath rejection and high out-of-band rejection.

Key Features

- Weight: 0,15 kg
- Dimensions: 65,5 mm x 21 mm (D x H)
- Colour: white
- Shape: conical

Mechanical characteristics

- **Vibration:** 3 axis, sweep = 15 min, sweep from 10 to 200 Hz: 3 g
- **Shock:** vertical axis: 50 g, each axis: 30 g
- **Ratio axis:** 4dB at 90°
- **Bracket:** in L or in tube

FASTENING KIT INCLUDING

- 1 hollow tube 20cm long
- 1 plate
- M6 and M8 nuts
- M6 and M8 washers
- Fixing brackets

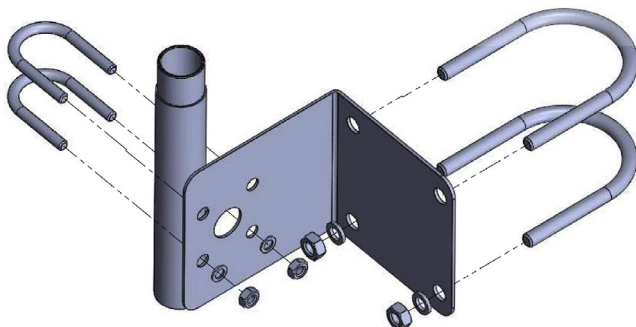

Environmental characteristics

- **Requirements:** RoHS, REACH, et RED
- **Operating temperature:** -40°C à +85°C
- **Storage temperature:** -45°C à +85°C
- **Humidity/Salt fog:** MIL-STD-810F Section 509.4
- **Waterproof:** IP67

Electrical characteristics

- **Frequency band:** L1 1575MHz \pm 10MHz
- **Polarization:** RHCP
- **Amplification gain (LNA):** 39 dB min.
- **Flatness gain:** \pm 2 dB, 1559 to 1606 MHz
- **Out-of-band discharge:**
 - $f < 1560$ MHz: >50 dB
 - $f > 1600$ MHz: >50 dB
 - $f > 1620$ MHz: >70 dB
- **VSWR output:** <1.5:1 typ. 1.8:1 max
- **Maximum noise:** 3 dB
- **DC Voltage:** 2,5 to 16 VDC nominal (max. 12VDC recommended)
- **Direct current:** 15 mA typ.
- **ESD Protection circuit:** 15 KV air discharge

